



LES RENCONTRES BIÊN NIÊN HỢP TÁC
**L'ADAPTATION
AU CHANGEMENT CLIMATIQUE**
des idées reçues pour nos plans d'actions territoriaux

L'Événement anthropocène : une révolution géologique d'origine humaine

Jean-Baptiste Fressoz
CNRS, Centre Alexandre Koyré

“The human imprint on the global environment has now become so large and active that it rivals some of the great forces of Nature in its impact on the functioning of the Earth system”

Will Steffen, Jacques Grinevald, Paul Crutzen et John McNeill, « The Anthropocene: conceptual and historical perspectives », *Philosophical Transactions of the Royal Society A*, vol. 369, n° 1938, 2011

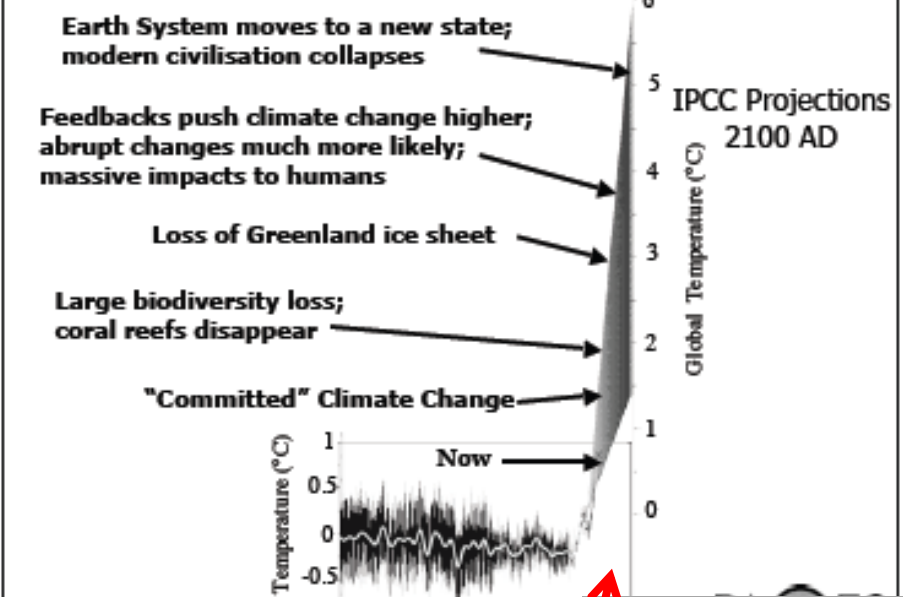

Pleistocene **Holo** **Anthropo-**
cene **cene**

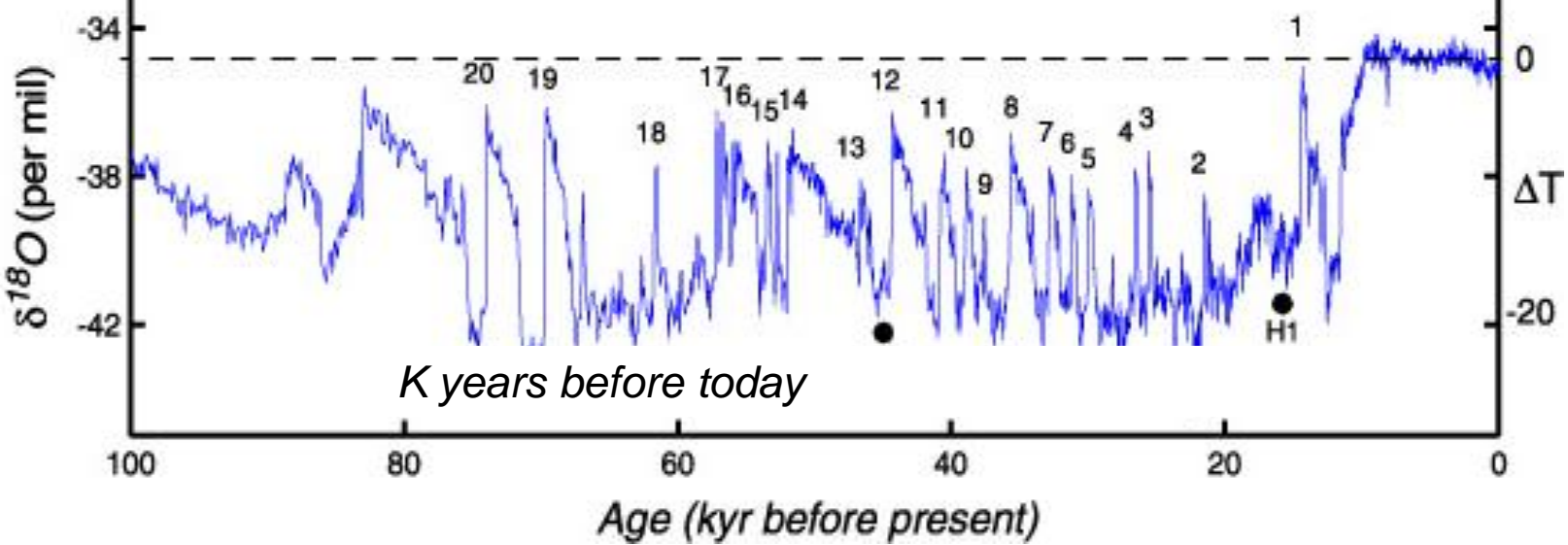

Paul J. Crutzen, « Geology of mankind », *Nature*, vol. 415, 2002.

EVOLUTION DES GAZ A EFFET DE SERRE TIREE DE DONNÉES OBTENUES À PARTIR DES CAROTTES DE GLACE ET DE MESURES RÉCENTES

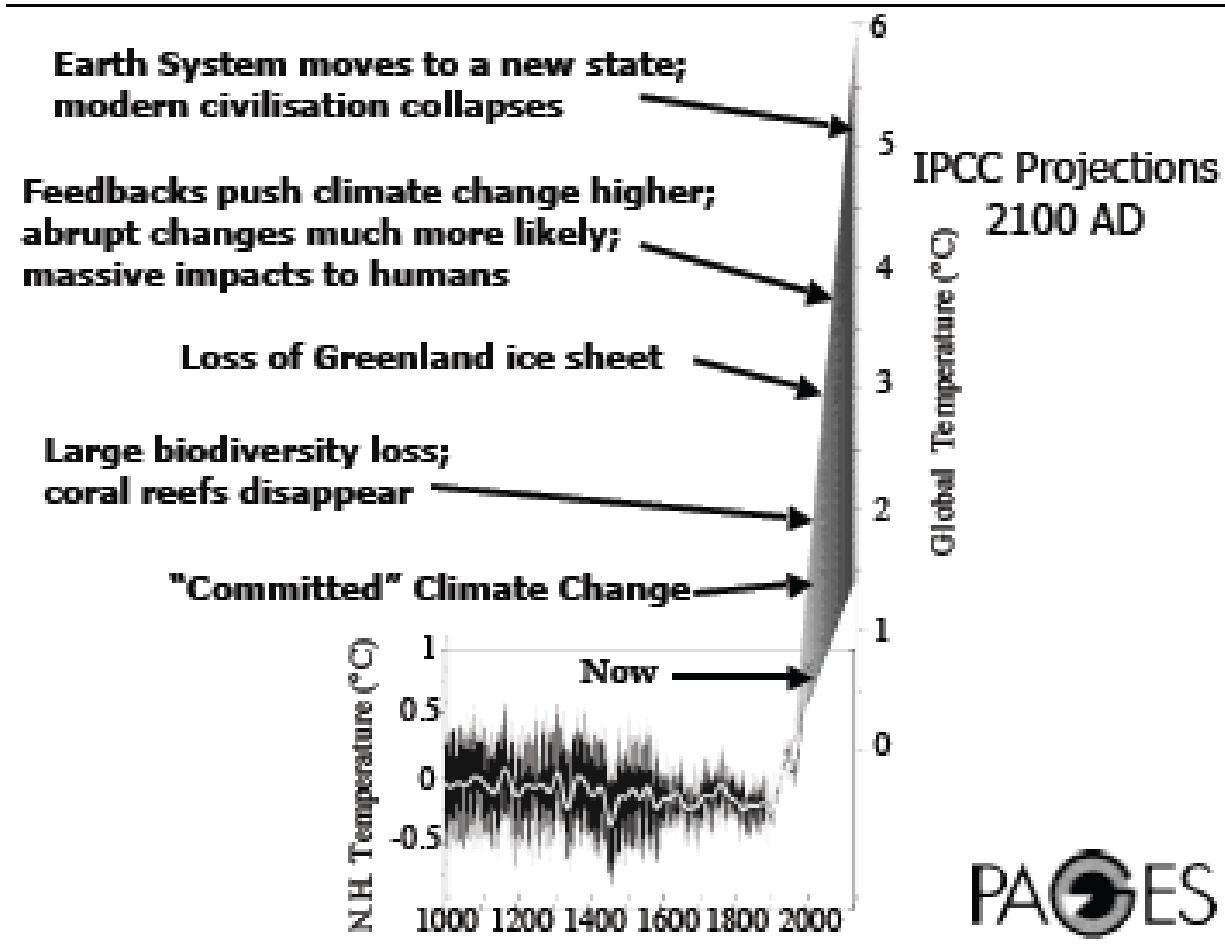
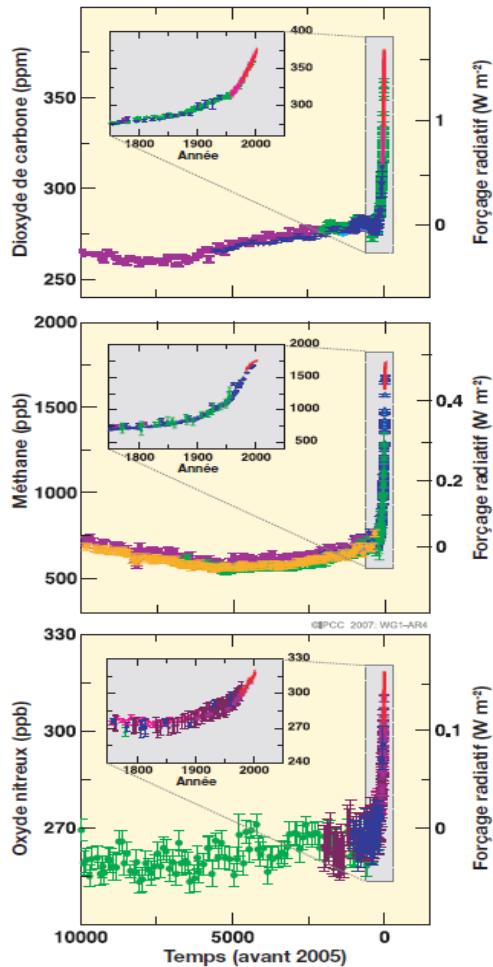

1. Nous sommes entrés dans l'Anthropocène sciemment

Changement climatique et adaptation au XIXe
siècle

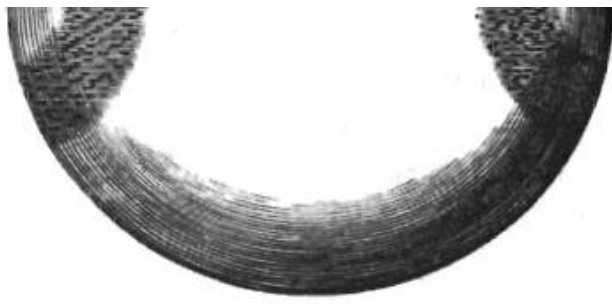

Le déboisement était pensé
comme une altération du cycle
global de l'eau

Book. 2^d

fig. 3.

p. 231

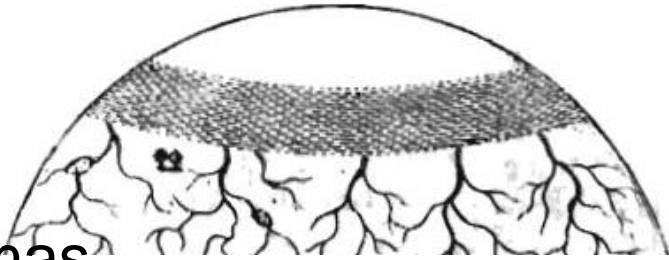

Thomas
Burnet, *Sacred
theory of the
earth*, 1684.

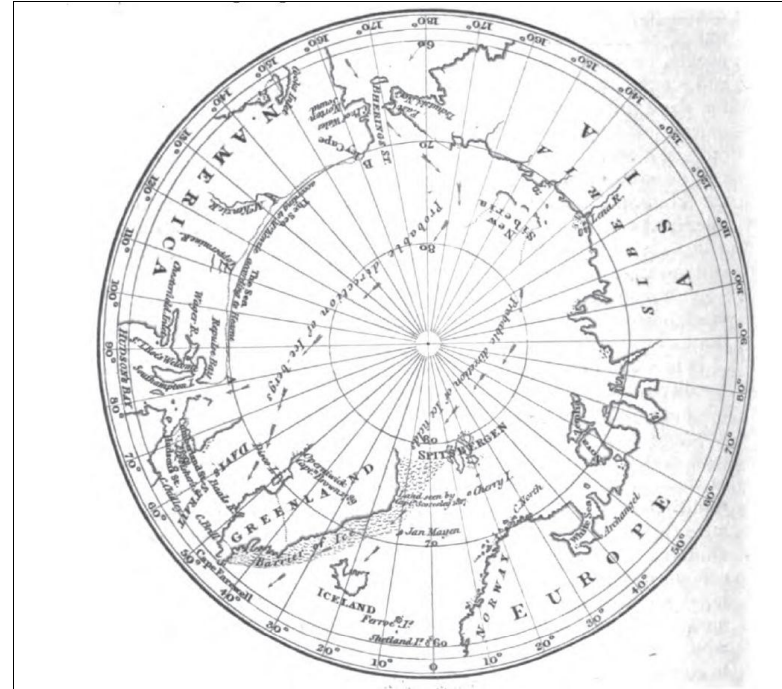



MESSIEURS, depuis quelques années, nous sommes témoins de refroidissemens sensibles dans l'atmosphère, de variations subites dans les saisons et d'ouragans ou d'inondations extraordinaires auxquels la France semble devenir de plus en plus sujette.

On l'attribue en partie aux déboisemens des montagnes, aux défriochemens des forêts, au défaut d'abri qu'éprouvent nos campagnes, et à l'absence des obstacles naturels qui s'opposaient jadis aux vents et aux nuages et du nord et de l'ouest.

Les mêmes causes produiraient les mêmes effets dans toute l'Europe, et ces phénomènes seraient dignes de fixer par-tout l'attention. Ces maux ne seraient pas sans remède, et il serait important que, particulièrement en France, on prît des mesures pour écarter les inconvéniens, les malheurs dont le principe aurait été reconnu.

Dans l'état actuel des observations, il est peut-être difficile d'asseoir un jugement; et c'est pour fixer mon opinion, pour voir ensuite quelles dispositions ordonner, que je viens vous demander des notes sur les divers points qui suivent :

1.° Quelles forêts existaient dans votre département il y a trente ans? Dans quelle zone et à quelle élévation étaient-elles



Les restes de Babylone, F.-A. Rauch, *Annales Européennes*, vol. 6, 1825.



La ramparts d'Angers

E. B. 100

2. Qui est l'anthropos de l'anthropocène?

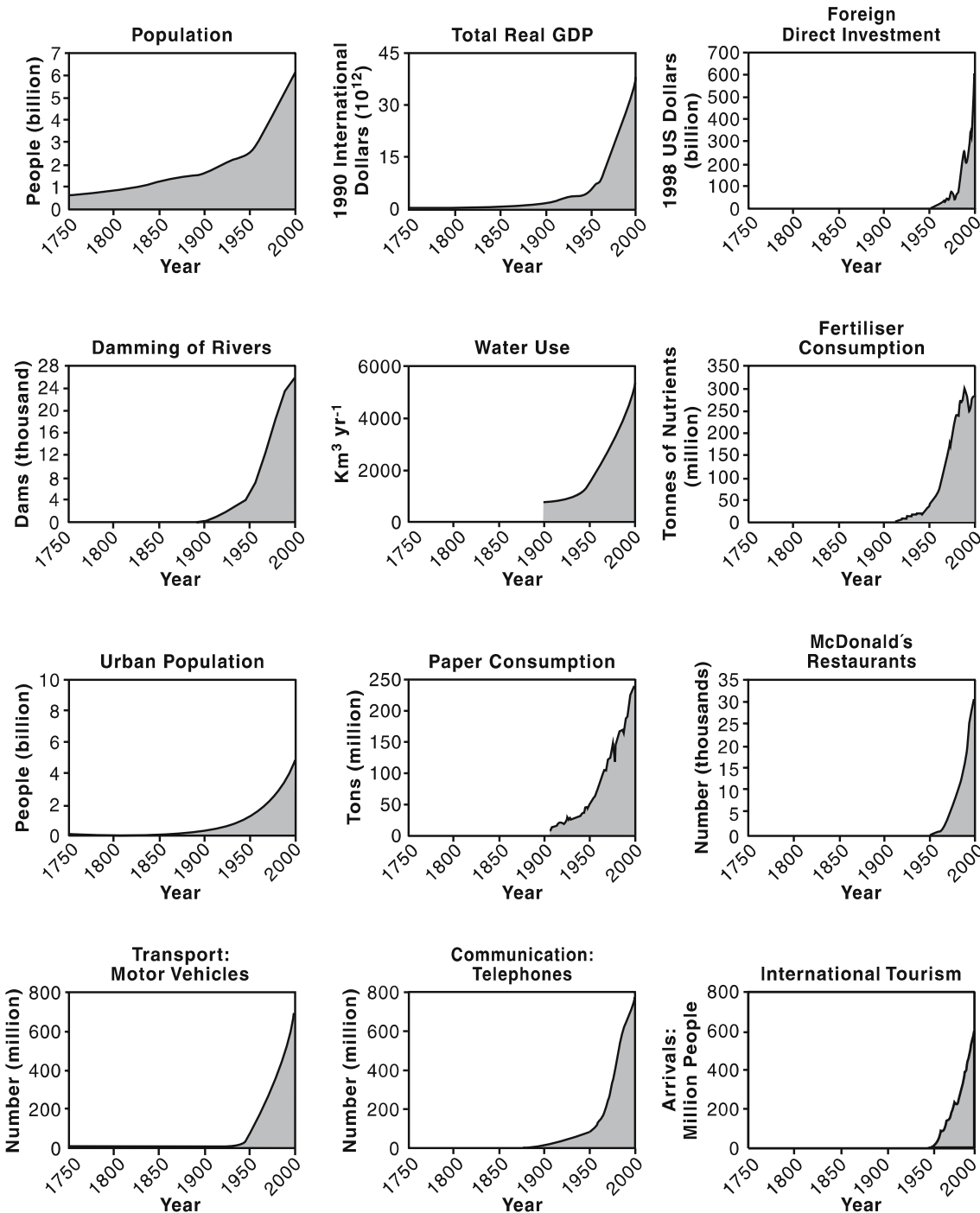

Steffen et al., *A Planet under Pressure*, 2005, p. 132

Une histoire politique du CO2

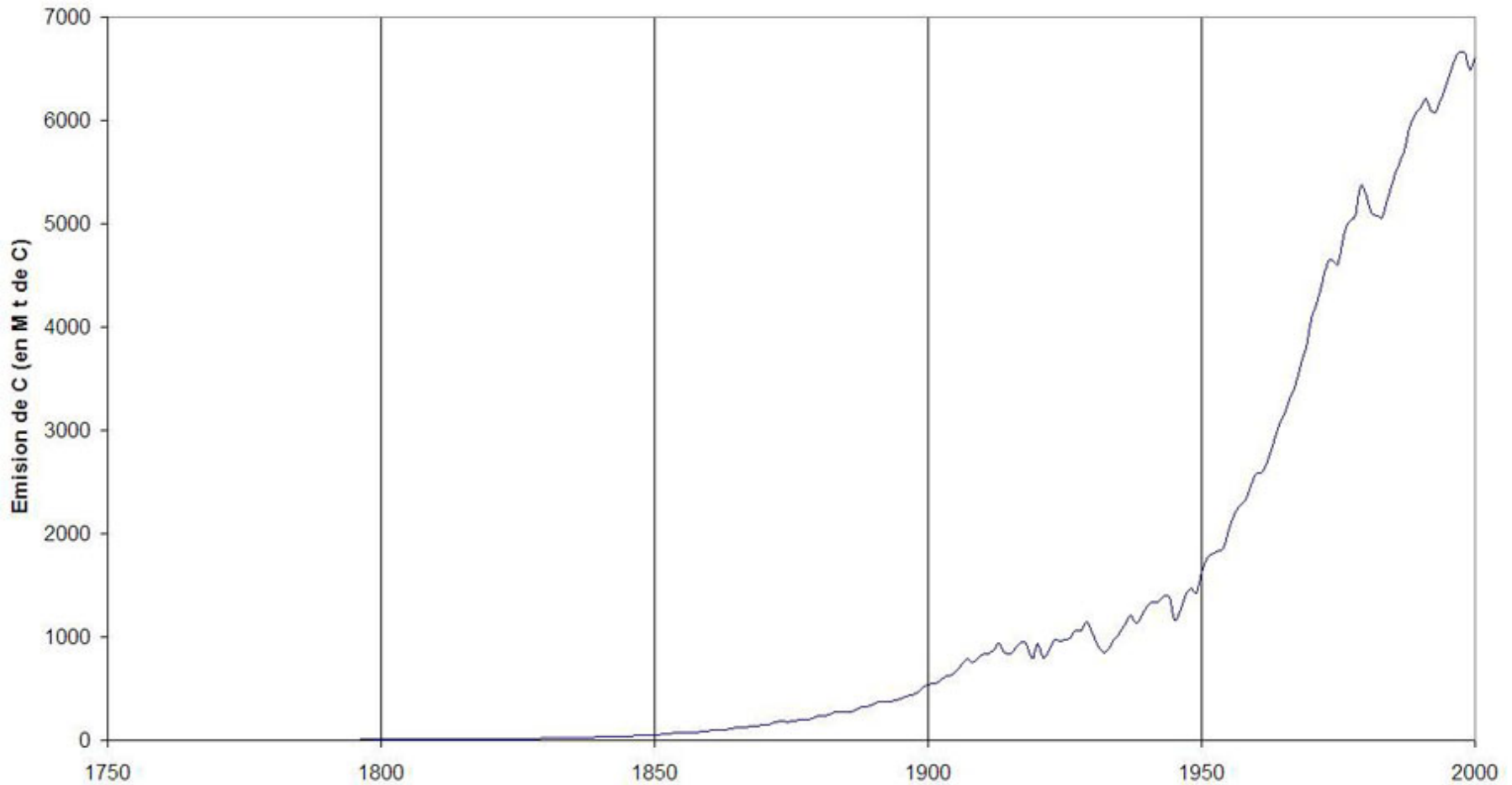

Source CDIAC, Oak ridge laboratory

L'Anthropocène est un Anglocène (jusque vers 1980)

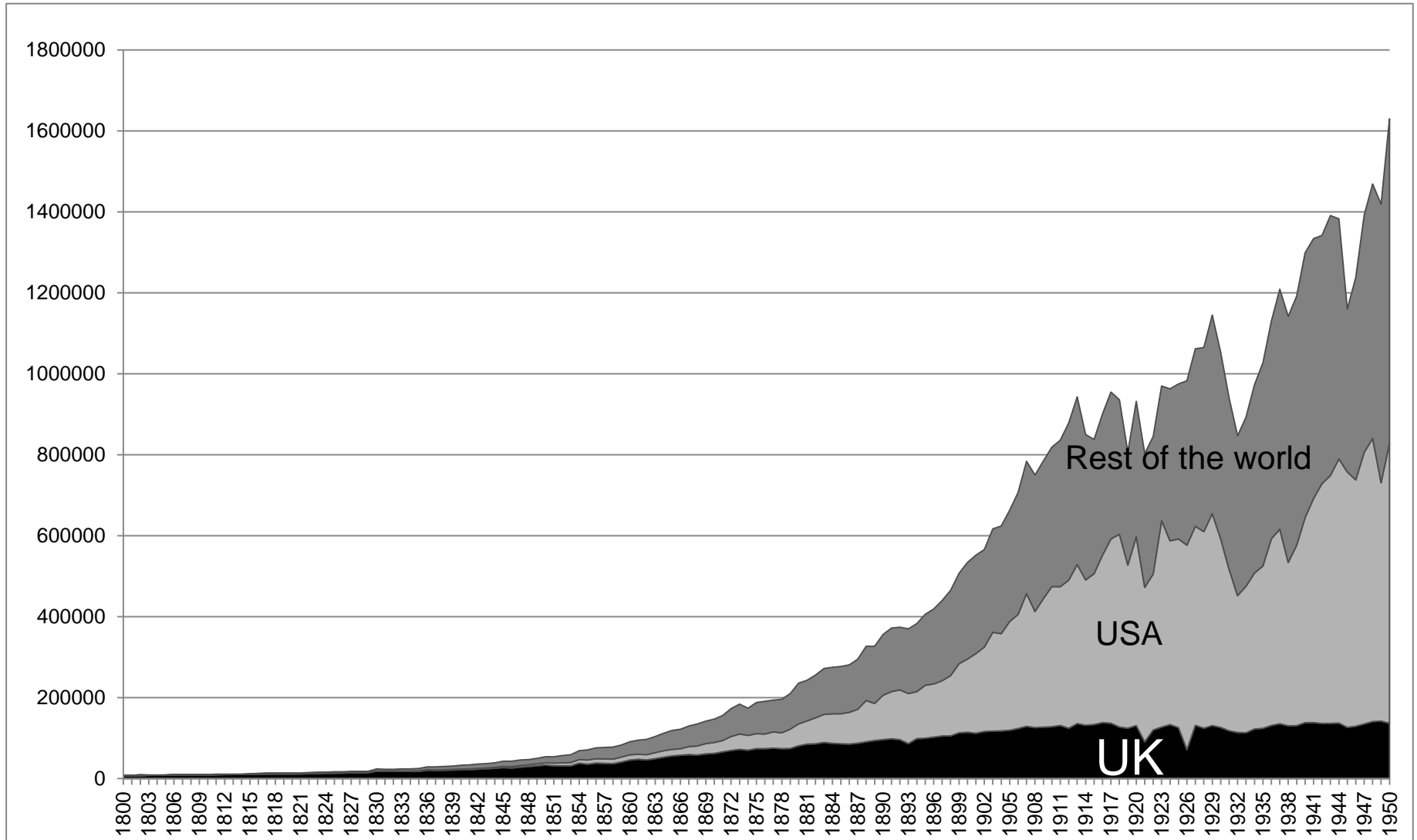

Source: CDIAC, Oak ridge laboratory

Emissions cumulatives depuis 1800

1900

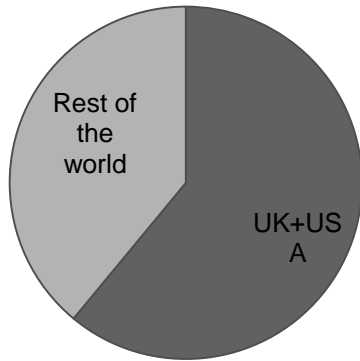

1950

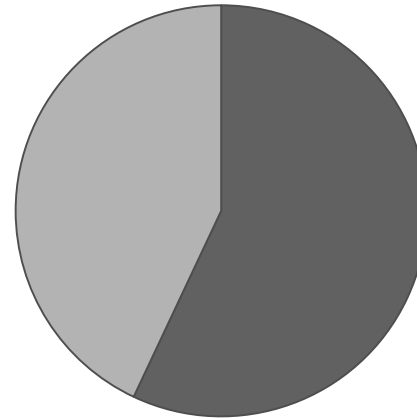

1980

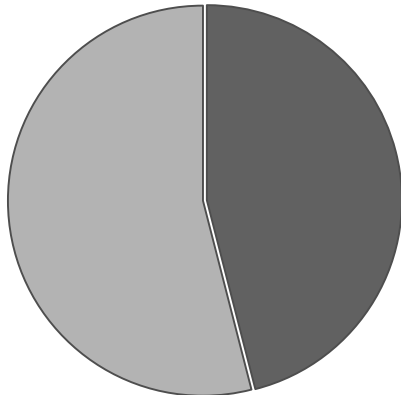

2008

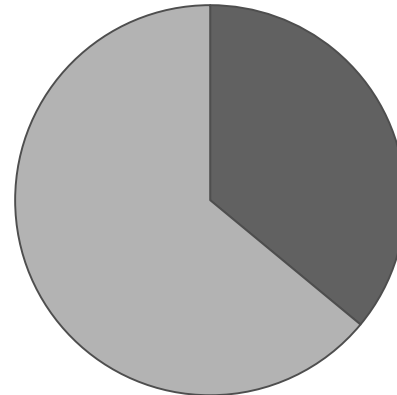

Emissions cumulatives de CO2 1800-1980

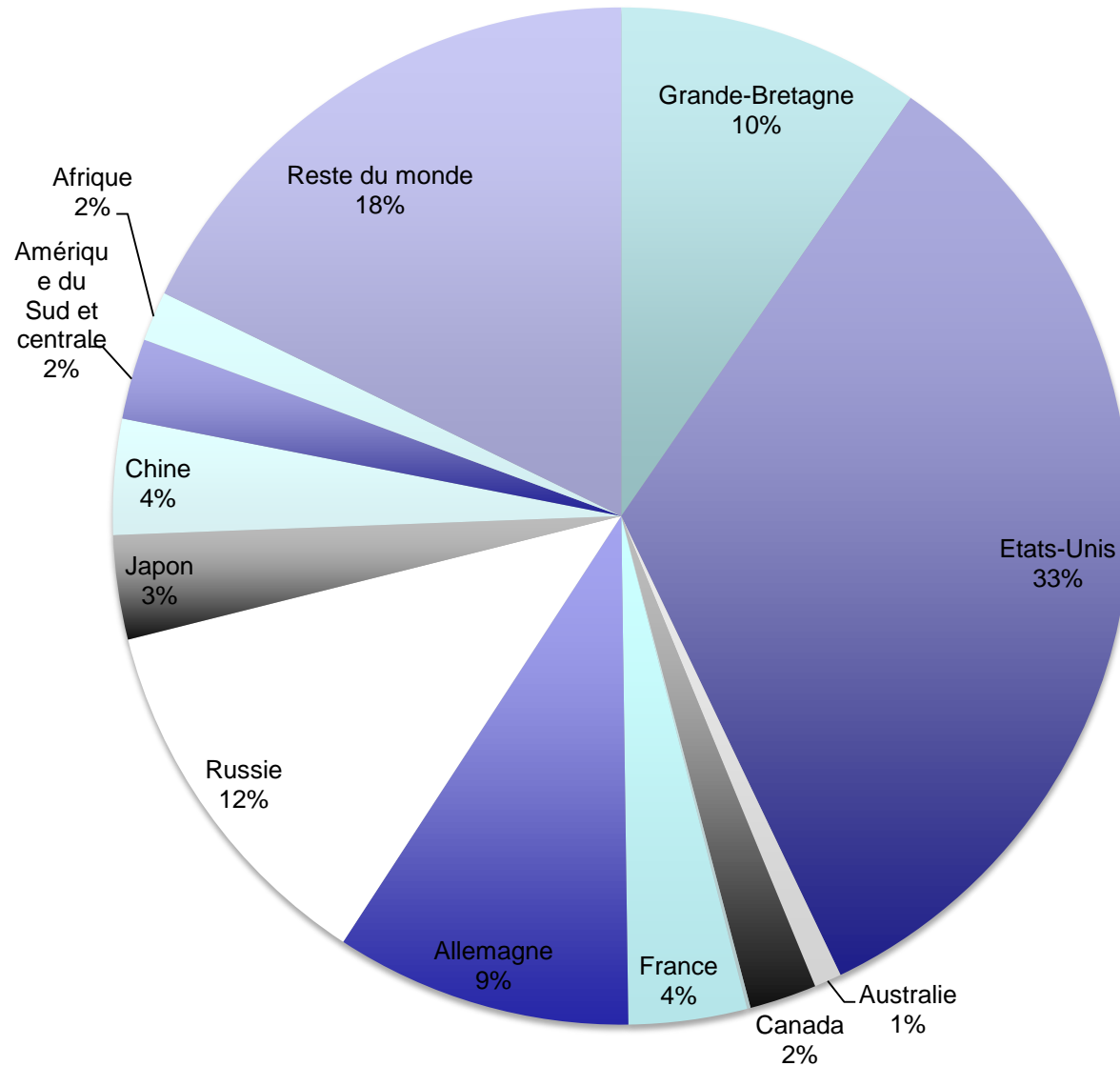

Balance commerciale physique et échange écologique inégal

data from Anke Schaffartzik, A. Mayer, S. Gingrich, N. Eisenmenger, C. Loy, F. Krausmann, « The global metabolic transition: Regional patterns and trends of global material flows », 1950–2010. *Global Environmental Change* 26, 2014, 87–97.

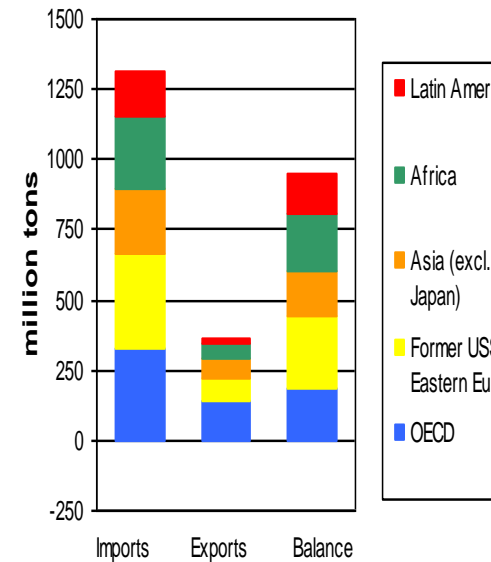
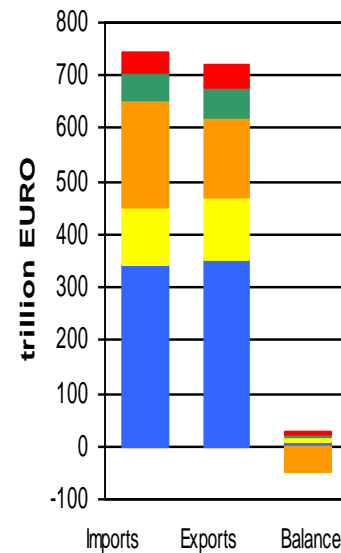
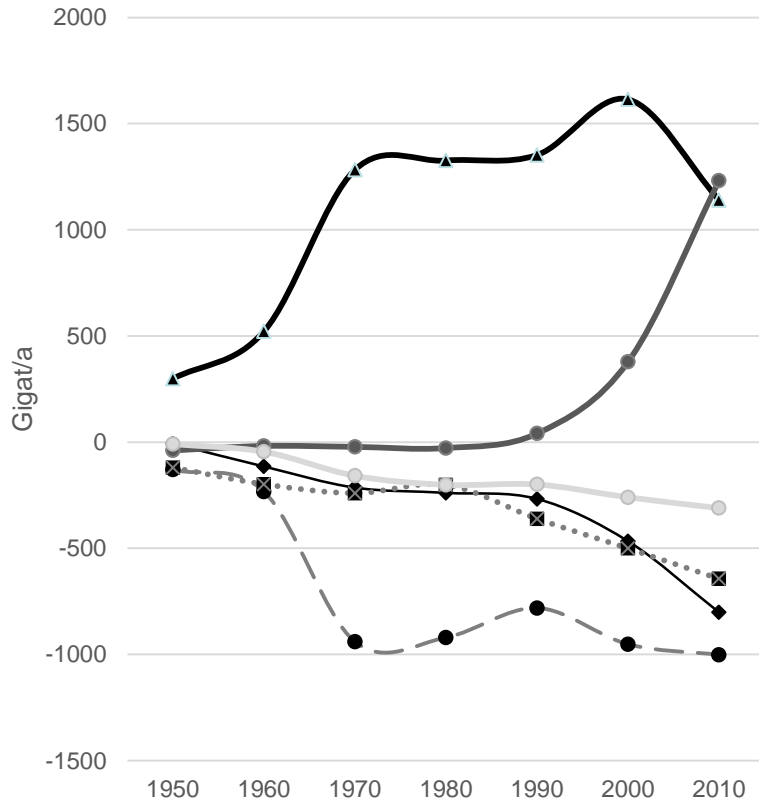

Exemple : balance commerciale physique de l'UE

3. L'anthropocène n'était pas inévitable

Thermopane 1932

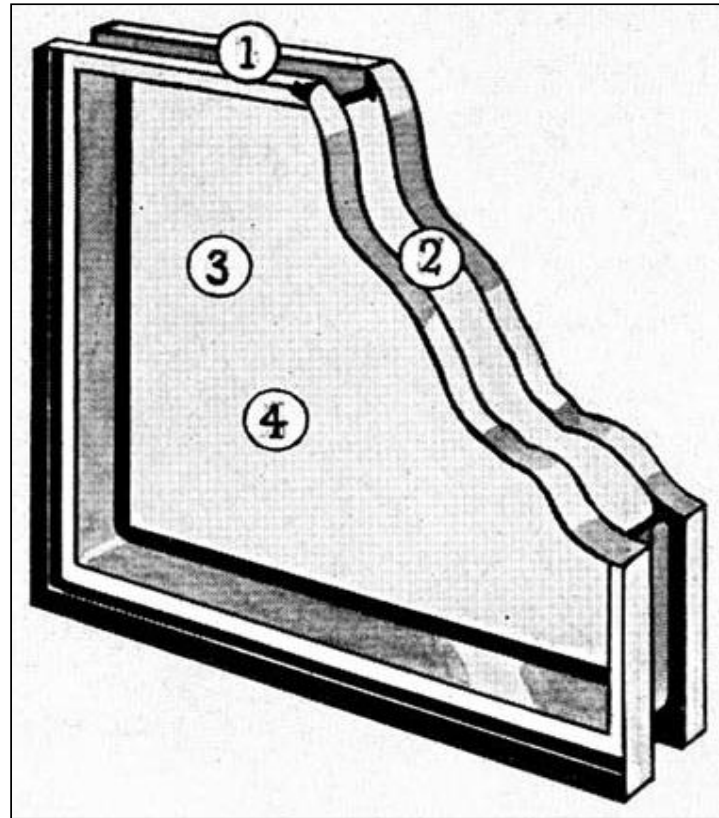

Keck, House of tomorrow, 1932.

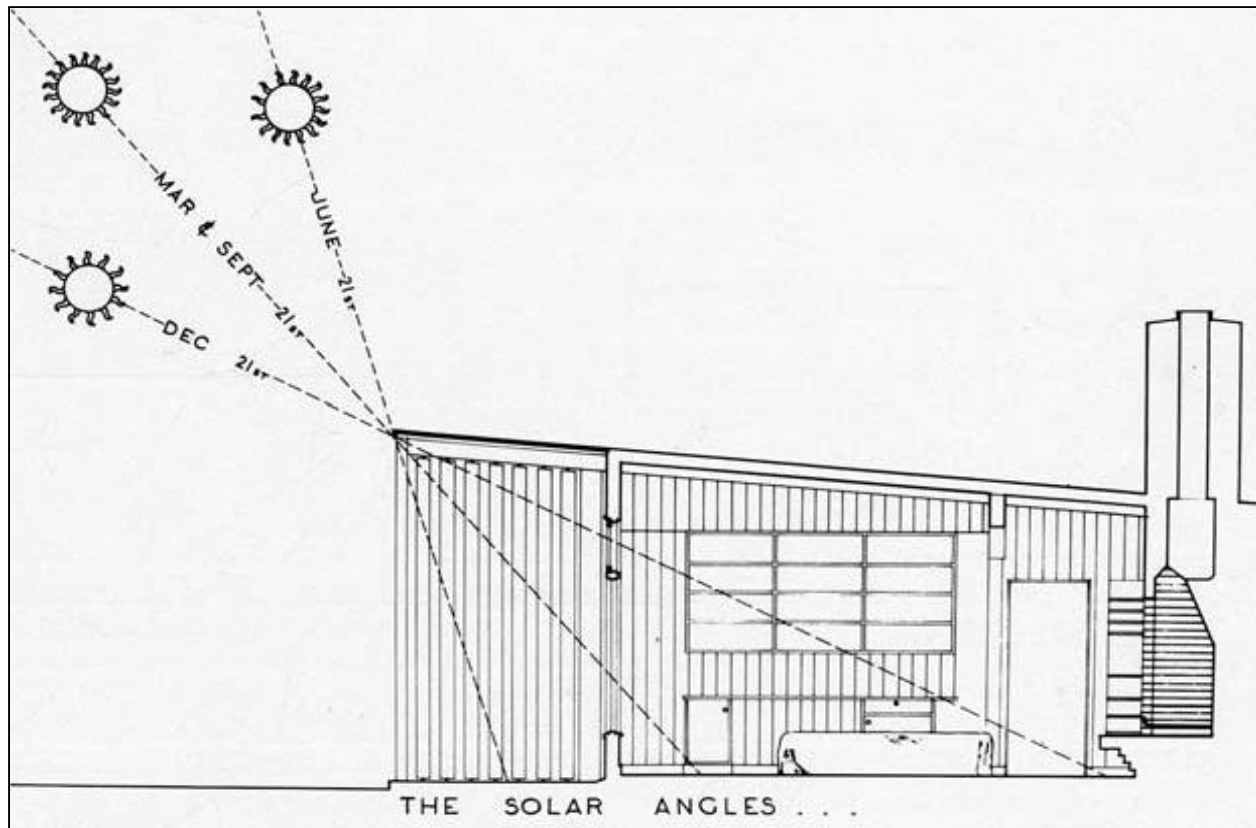







House in the Sun

All rooms open on sunny terrace, garden or playground.

BY RICHARD PRATT
Architectural Editor of the Journal

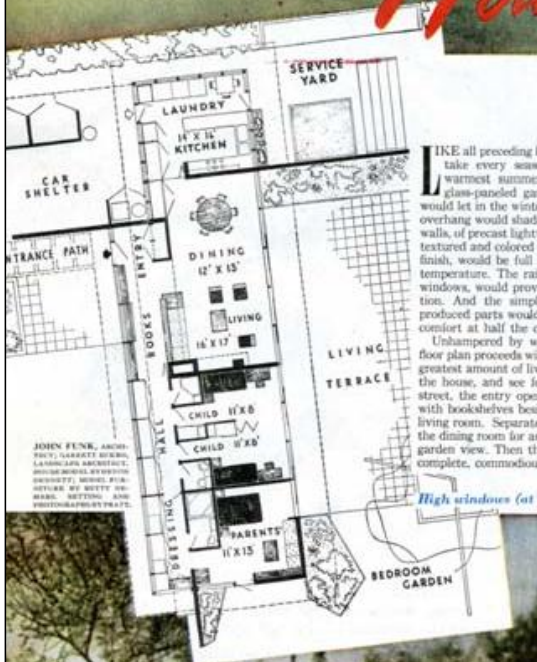

LIKE all preceding houses in the series, this one would take every season in its stride—coldest winter, warmest summer—anywhere within reason. The glass-paneled garden side, away from the street, would let in the winter sun warmth, while its wide roof overhang would shade the rooms in summer. The other walls, of precast light weight concrete panels, beautifully textured and colored for appropriate inside and outside finish, would be full insulation against all extremes of temperature. The raised roof, with its high clerestory windows, would provide still further light and ventilation. And the simplicity and fewness of the mass-produced parts would make possible all this space and comfort at half the cost of conventional construction.

Unhampered by worn-out restrictions of style, the floor plan proceeds with perfect freedom to give you the greatest amount of livability attainable. Take a tour of the house, and see for yourself. Coming in from the street, the entry opens on a long passage that begins with bookshelves beside the large daylight-illuminated living room. Separated at will by a folding partition is the dining room for as many as eight, and the same full garden view. Then the kitchen and laundry; pleasant, complete, commodious, with an entrance from the car

shelter, which contains heating plant and storage compartments. Now back to the passage with the books, the corridor, lined with large closets, leads to the bedrooms and becomes a dressing room for the parents' bedroom at the end. Notice, in passing, the children's, which can be singles or double, and their two cleverly divided baths. And remember that skillful planning without guarantees privacy and outlook wishing; also that skillful planning of house and grounds must continue on to cover the community—for the livability of the neighborhood is what gives value and security to the home.

The hope for houses like this, at prices you can afford, is within your power to realize. Better houses, at lower costs, and put together with infinitely fewer parts, all greatly improved and simplified, can be had if the same kind of research and co-ordination which are winning the war can only be used to revitalize the home-building industry. You can urge your congressman to back legislation which will initiate and stimulate research that will create the better, less expensive homes you need. You can help discourage present inflationary costs by waiting for that better, less expensive home. Wartime research quickly developed the B-29; similar effort can soon develop the better home so vital to a victorious peace.

High windows (at lower left) give privacy from the street. The terrace is like an outdoor room.



Ladies' home journal, 8 août 1945, Funk's House.

TIME

THE WEEK'S MAGAZINE

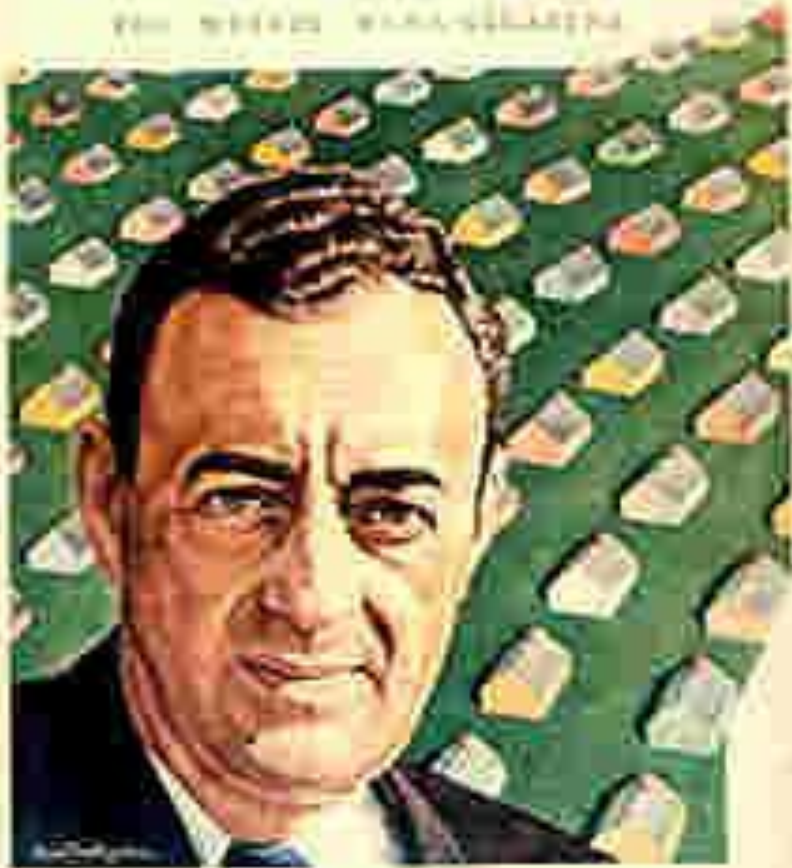

Une histoire
politique de
domination















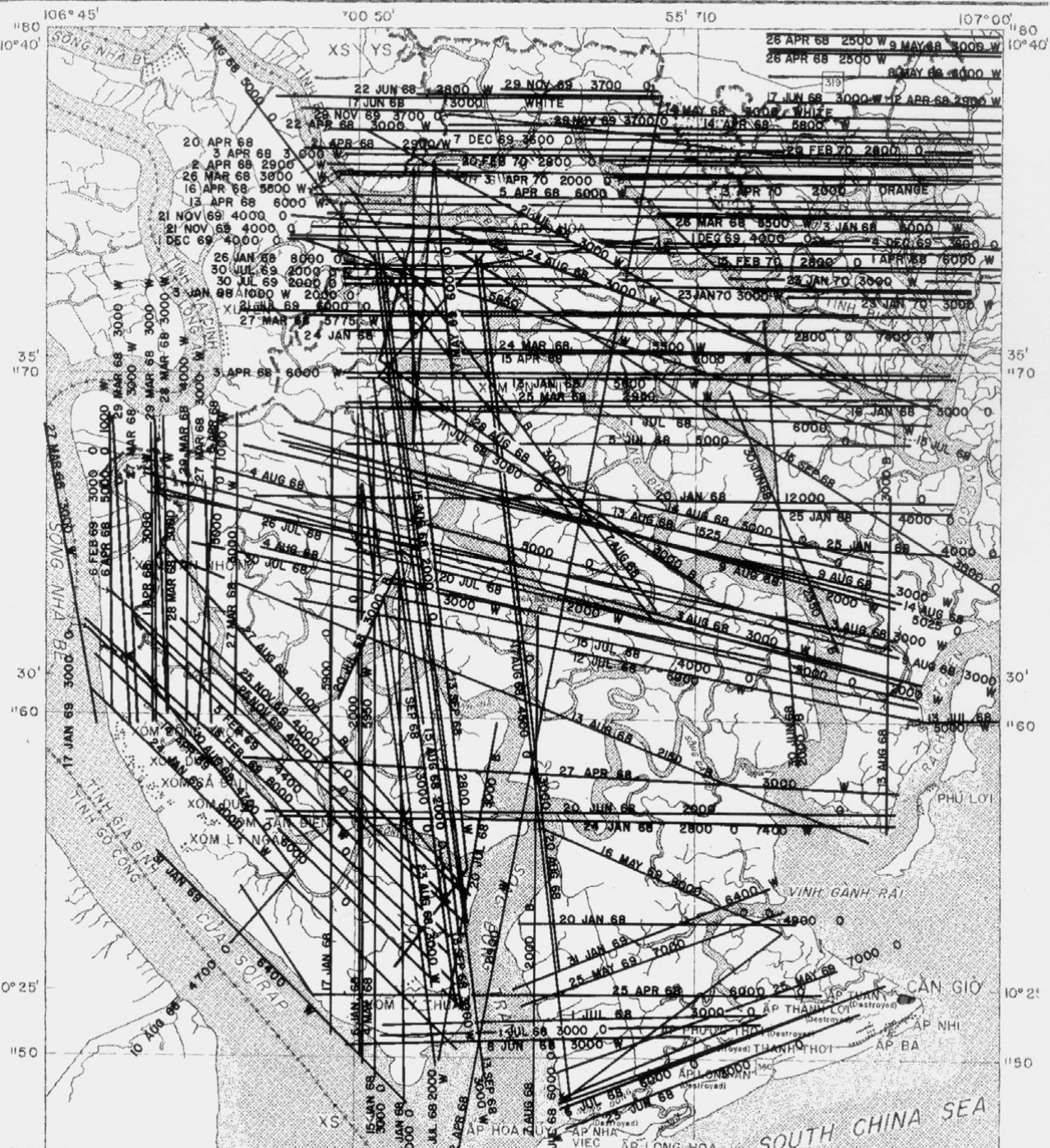

26 APR 68 2500 W 9 MAY 68 3000 W
 28 APR 68 2500 W 8 MAY 68 4000 W

22 JUN 68 2800 W 29 JUN 68 3700 W
 17 JUN 68 3000 W WHITE
 28 NOV 68 3700 W 22 APR 68 3000 W
 22 APR 68 3000 W 10 FEB 70 2800 W
 20 APR 68 2900 W 14 APR 68 5800 W
 3 APR 68 3000 W 28 FEB 70 2800 W
 2 APR 68 2900 W 5 APR 68 6000 W
 26 MAR 68 5500 W 3 JAN 68 6000 W
 16 APR 68 5800 W 14 APR 68 5800 W
 13 APR 68 6000 W 5 APR 68 6000 W
 21 NOV 69 4000 W 28 MAR 68 5500 W
 21 NOV 68 4000 W 15 APR 68 6000 W
 DEC 69 4000 W 15 APR 68 6000 W
 26 JAN 68 8000 W 25 FEB 70 2800 W
 30 JUL 69 4000 W 25 JAN 70 3000 W
 30 JUL 69 2000 W 25 JAN 70 3000 W
 3 JAN 68 1000 W 2000 W 25 JAN 70 3000 W
 27 MAR 68 5775 W 24 MAR 68 3000 W
 24 MAR 68 3000 W 15 APR 68 6000 W
 3 APR 68 6000 W 18 JAN 68 5800 W
 18 JAN 68 5800 W 25 MAR 68 2800 W
 24 MAR 68 3000 W 15 APR 68 6000 W
 15 APR 68 6000 W 18 JAN 68 5800 W
 25 MAR 68 2800 W 18 JAN 68 5800 W
 24 MAR 68 3000 W 15 APR 68 6000 W
 15 APR 68 6000 W 18 JAN 68 5800 W
 25 MAR 68 2800 W 18 JAN 68 5800 W
 24 MAR 68 3000 W 15 APR 68 6000 W
 15 APR 68 6000 W 18 JAN 68 5800 W
 25 MAR 68 2800 W 18 JAN 68 5800 W

35' 170

35' 170

30' 160

30' 160

10° 25'

10° 25'

11° 50'

11° 50'

11° 47'

11° 47'

SOUTH CHINA SEA



ROBERT
ZINNER



HOW 10 H-BOMBS CAN DESTROY THREE-FOURTHS OF THE STEEL INDUSTRY

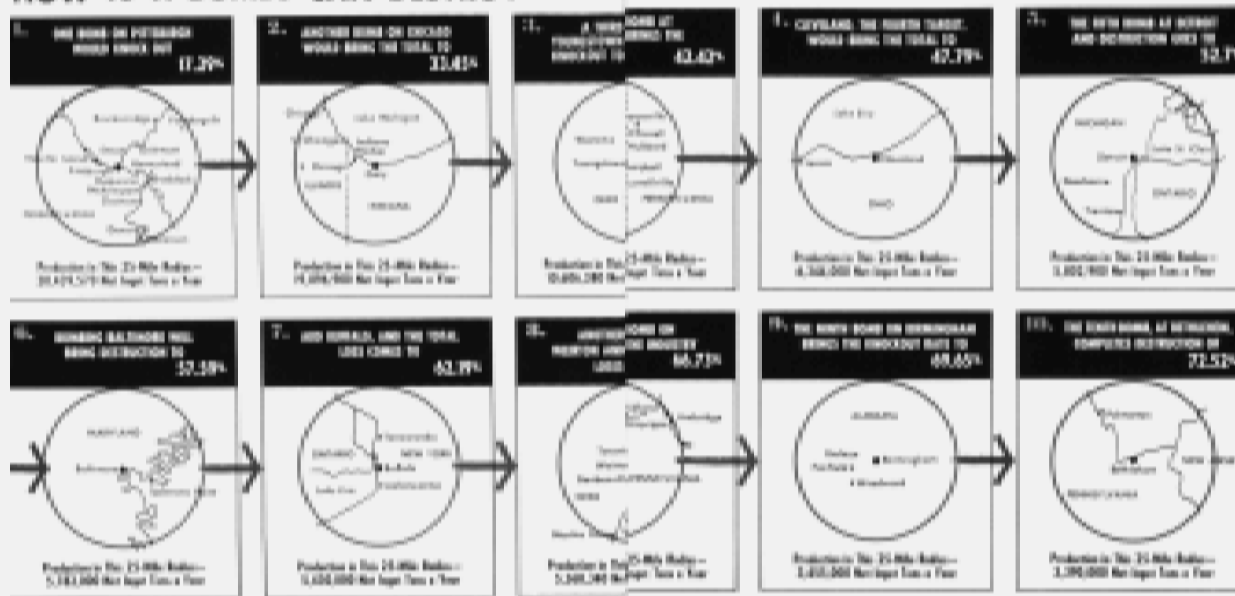

Conclusion : l'adaptation une
nécessité impérieuse et un
discours pernicious.

GLOBAL
WARMING
READY



DIESEL

GLOBAL
WARMING
READY



DIESEL



GLOBAL
WARMING
READY

DIESEL